

# UNION TOWNSHIP SECTION 19 R 13 TWP 8 MORGAN COUNTY, OHIO

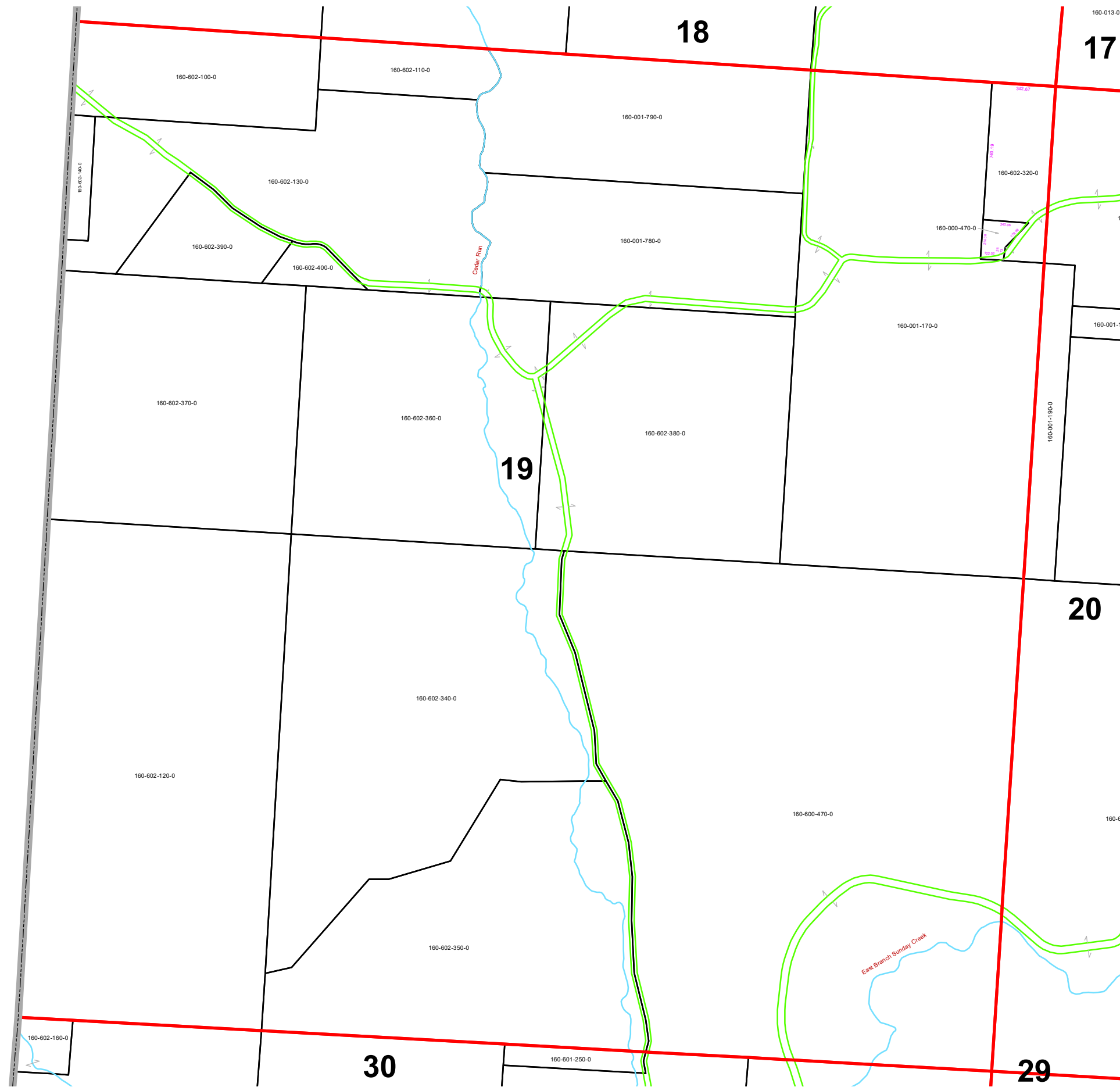

PIN	Owner	LegalDescr	Acres	VOL	PAGE	Survey_Ref
160-001-170-0	COMSTOCK BRUCE A	R13 T08 S19 SD 1	72.52	OR234	2564	NoSurvey.pdf
160-001-780-0	FEKETE ELMER D ET AL	R13 T08 S19 SD 14-19	30	OR226	823	NoSurvey.pdf
160-001-790-0	FEKETE ELMER D ET AL	R13 T08 S19 SD 2-20 E	26	OR226	823	NoSurvey.pdf
160-000-470-0	SHRINER BRADLEY & JULIE	R13 T08 S19 SD 16 SUR	0.81	OR167	587	UNN-0256.pdf
160-600-470-0	STATE OF OHIO	R13 T08 S19 LOT 10 EX	129	D.V 97	431	NoSurvey.pdf
160-602-350-0	UNITED STATES OF AMERICA	R13 T08 S19 S D 9-22	55.56	D.V 155	449	NoSurvey.pdf
160-602-340-0	UNITED STATES OF AMERICA	R13 T08 S19 S D 8-21	55.89	D.V 156	346	NoSurvey.pdf
160-602-120-0	UNITED STATES OF AMERICA	R13 T08 S19 LOT 7	80	D.V 92	226	NoSurvey.pdf
160-602-380-0	UNITED STATES OF AMERICA	R13 T08 S19 S D 13 EX	40	D.V 155	449	NoSurvey.pdf
160-602-360-0	UNITED STATES OF AMERICA	R13 T08 S19 S D 3 EX C	40	D.V 155	449	NoSurvey.pdf
160-602-370-0	UNITED STATES OF AMERICA	R13 T08 S19 S D 6 EX C	40	D.V 92	585	NoSurvey.pdf
160-602-400-0	UNITED STATES OF AMERICA	R13 T08 S19 S D 17	3	D.V 156	461	NoSurvey.pdf
160-602-320-0	UNITED STATES OF AMERICA	R13 T08 S19 S D 15 EX	6.42	D.V 92	585	NoSurvey.pdf
160-602-390-0	UNITED STATES OF AMERICA	R13 T08 S19 S D 23	7			NoSurvey.pdf
160-602-140-0	UNITED STATES OF AMERICA	R13 T08 S19 LOT 18	2	D.V 92	537	NoSurvey.pdf
160-602-100-0	UNITED STATES OF AMERICA	R13 T08 S19 LOT 4	15	D.V 92	537	NoSurvey.pdf
160-602-110-0	UNITED STATES OF AMERICA	R13 T08 S19 LOT 5	6			NoSurvey.pdf
160-602-130-0	UNITED STATES OF AMERICA	R13 T08 S19 LOT 11-12	31	D.V 92	585	NoSurvey.pdf

**Boundaries**

- Hydro
- Section
- Roads
- Lot
- County
- Parcel
- Township
- ROW



Disclaimer: The information that these maps contains is for reference purposes only. Please bring any erros to the attention of the Engineer's Office staff. Thank you

Source: Morgan County Engineer's Office  
 Author: Marcia Wolfe  
 Date: 02/10/20

